

Copyright: of this drawing is vested in the Architect and it must not be copied or reproduced without consent. **Printing:** Please note that paper prints of this drawing may not be an accurate reproduction of the given scale. Key dimensions are noted for reference. Purpose: Unless marked as such drawing should not be used for Construction purposes. Detailed setting out drawings will need to be supplied for Tender and Construction purposes. Figured dimensions only are to be taken from this drawing. All Dimensions and Levels are to be checked on site, prior to commencement. All contractors are to be responsible for taking and checking all dimensions relative to their work. Dimensions are in millimetres unless otherwise stated. bpArchitecture are to be advised of any variation between drawings and site conditions. Co-Ordination This drawings is to be read in conjunction with all other consultants drawings, specifications and schedules.

CDM: Work must not start on site before a Construction Phase Health and Safety Plan is in place (if applicable). The Client is responsible for ensuring that a Principal Designer and/or Principal Contractor has been appointed and the Health and Safety executive have been notified (for projects which will involve more than 500 person days and/or will last more than 30 working days on site).....IF IN DOUBT ASK

Rev	Drawn	Comments	Date
1	BPA	For Client Comment/Sign Off	Oct 2020
2	BPA	Tender.	16 Oct 2020

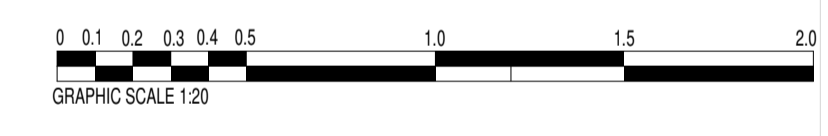
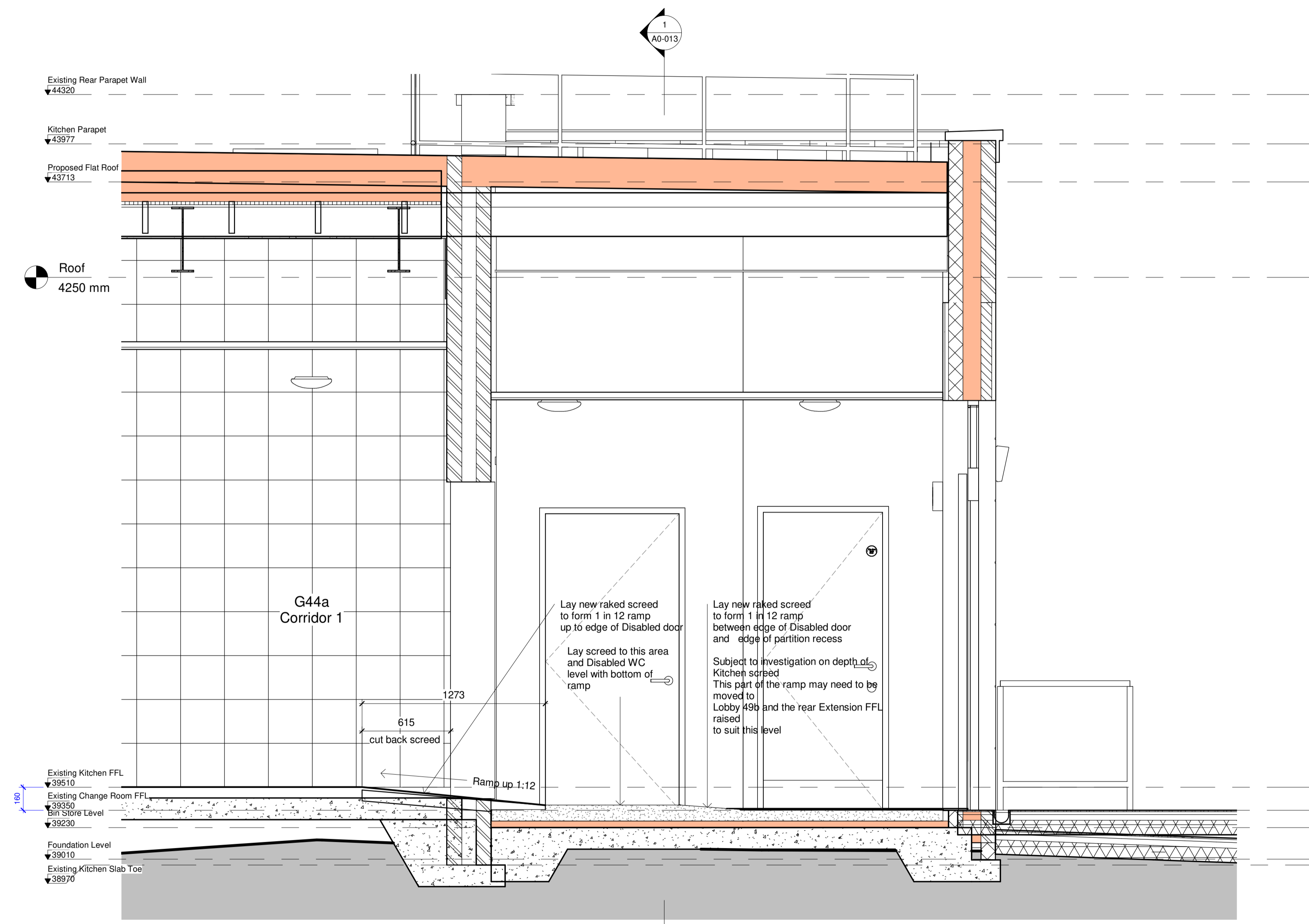

Proposed Corridor 1 Ramp 1 : 20

FIRST Priority at Start on site
As a first priority when works commence on Site Investigate the depth of the Screed to the proposed corridor in the corner of the existing kitchen to determine total depth of screed and whether there is any insulation, drill two holes one to determine raft toe and one to determine screed depth
This may allow the ramp to be pulled back along the corridor, and determine exact position and depth available to ramp
The Disabled WC door must open into the corridor onto a flat landing and so that the door can be pushed closed in the direction of escape.

- Ramp Length:**
1920mm required to achieve 160mm level change at 1 in 12
- Option 1:** As drawn
Construct the ramp as far left as possible, removing the kitchen screed to corridor area, but not the raft cover installing a new structural screed at 1 in 12 to form the ramp ensure that the area in front of the Disabled WC door is level The depth of existing screed will determine where the Proposed floor level to the extension can be set Ideally this should be 160mm lower. BUT THIS MAY NOT BE POSSIBLE
 - Option 2:** If the entire ramp cannot be pulled further back
Construct the ramp in two parts
As much as possible within the existing corridor and to the left of the disabled door then a second section of ramp to the right of the disabled door to the corner of the wall (future staircase) Ensure that the area in front of the disabled door is level and the area in front of the Staircase and entrance doors is level
 - Option 3:** Construct the ramp in two parts
With FFL level to the extension raised and the second part of the ramp put in in the Entrance lobby 49b to bring the Extension floor level to the Changing Block Floor level This will adjust the Step required at Door DG-13

bpArchitecture
01782 515 555
Enquiries@bpArchitecture.co.uk
www.bparchitecture.co.uk
93 High Street Biddulph Staffs ST8 6AB
Architects : Conservation : Interior Architecture : Landscape

Tender Important

Client
Nantwich Town Council

Project
Proposed Alterations and Extension to Nantwich Civic Hall, 4 Market St, Nantwich CW5 5NF

Title
Proposed Corridor 1 Ramp

Package **2 Superstructure**
Dwg Stage **RIBA Stage 4A: Technical Design**

Date **October 2020** Drawn **SS/BSP**
Scale @A1 **1 : 20** Checked **BSP**

Project No **20-051-BPA-CH-00-DR- A2-020 T 2**

Print Date: 16/10/2020 12:45:36