

Copyright: of this drawing is vested in the Architect and it must not be copied or reproduced without consent. **Printing:** Please note that paper prints of this drawing may not be an accurate reproduction of the given scale. Key dimensions are noted for reference. **Purpose:** Unless marked as such drawing should not be used for Construction purposes. Detailed setting out drawings will need to be supplied for Tender and Construction purposes. **Figured dimensions only** are to be taken from this drawing. All Dimensions and Levels are to be checked on site, prior to commencement. All contractors are to be responsible for taking and checking all dimensions relative to their work. Dimensions are in millimetres unless otherwise stated. bpArchitecture are to be advised of any variation between drawings and site conditions. **Co-Ordination:** This drawing is to be read in conjunction with all other consultants drawings, specifications and schedules. **CDM:** Work must not start on site before a Construction Phase Health and Safety Plan is in place (if applicable). The Client is responsible for ensuring that a Principal Designer and/or Principal Contractor has been appointed and the Health and Safety executive have been notified (for projects which will involve more than 500 person days and/or will last more than 30 working days on site).....IF IN DOUBT ASK

Rev	Drawn	Comments	Date

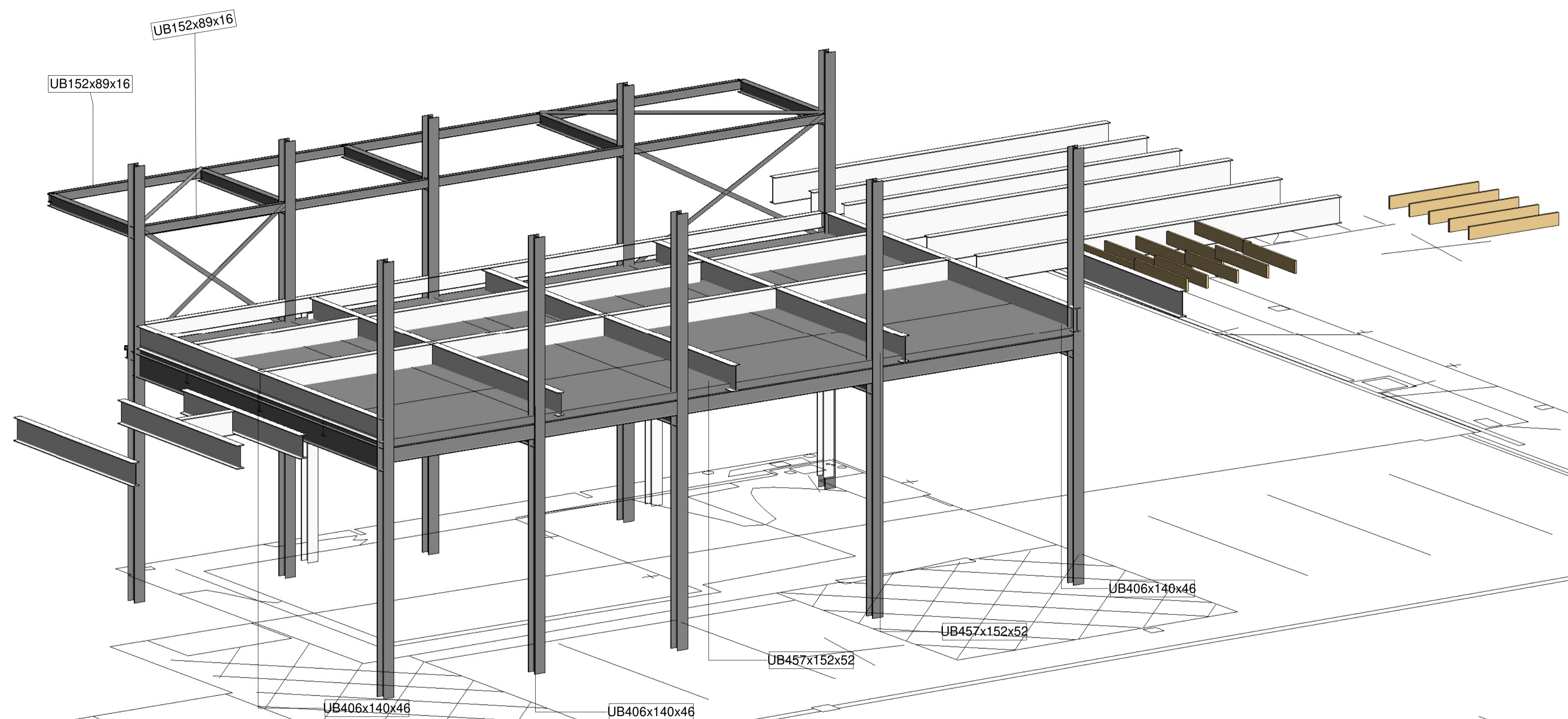

A2-3D Steel

**bpArchitecture**  
 01782 515 555  
 Enquiries@bpArchitecture.co.uk  
 www.bparchitecture.co.uk  
 93 High Street Biddulph Staffs ST8 6AB  
 Architects : Conservation : Interior Architecture : Landscape

For Information

Client  
**Nantwich Town Council**

Project  
**Proposed Alterations and Extension to Nantwich Civic Hall, 4 Market St, Nantwich CW5 5NF**

Title  
**Proposed 3D Steel Model**

Package **2 Superstructure**  
 Dwg Stage **RIBA Stage 4A: Technical Design**

Date **September 2020** Drawn **SS**

Scale @A1 Checked -

Project No	Originator	Block	Level	Type	File Element	Role	Drawing No	Rev
20-051-BPA-CH-00-MR-	A2-010	P					NNN	